



# Fine Arts & Dual Language

Program Update



A 3D speech bubble with a white border and a blue scribbled background. The word "BIENVENIDOS" is written in white, bold, uppercase letters across the center. The bubble has a slight shadow underneath, giving it a three-dimensional appearance.

**BIENVENIDOS**

- **Differentiated and innovative** learning experience
- **Accelerate** students' opportunities to refine skills and talents correlated to their interests
- **Effectively prepare** for a highly competitive secondary and post-secondary fine arts experience
- Advance opportunities to further increase **language mastery** and acquire seal of bi-literacy

## PROGRAM GOALS



## Dual Language Programs

prepare students for a global workforce and productive community service.



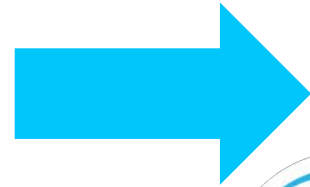



# FINE ARTS PROGRAM CONSIDERATIONS

## **Band, Orchestra and Choir**

Upper level ensemble courses

Top junior high ensembles based on readiness

## **Piano**

Differentiated piano classes

Group recitals and performances

Lead to extremely advanced courses at Fine Arts Center

## **Art**

Accelerated courses; expanded pallet due to 2D and 3D elementary exposure

Possible fabrication/maker space room

Potential AP readiness upon entry in high school leading to multiple high school endorsements within the arts

## **Theater**

K-5 exposure to theater training offers unique prep for secondary

Advanced study of theater production and technical theater

Possible access to UIL One Act Play for 6<sup>th</sup> graders

## **Dance**

Focus on Ballet, Modern, Contemporary and Jazz courses

Matriculate to Fine Arts Center in high school w/ audition criteria

# Grade 6

- Access to:
  - Specialized staff expertise
  - Skill demonstration
  - Increased time
  - Competition readiness
  - Coursework acceleration
- Participation in a state-of-the-art facility designed specifically with fine arts specialization in mind.

- Stantec Architecture Firm
- Program design & space requirements
  - Band, percussion, orchestra and choir rooms
  - Theater setting (stage, sound and light) and dressing room
  - Art labs (2D, 3D and 4D) with kiln room and storage
  - Dance Studio
  - Fabrication/maker Space
- Longitudinal enrollment trends
  - School within a school model
- Utilization capacity of area schools
- Transportation & Accessibility
- Long-term sustainability

# FACILITY CONSIDERATIONS



# DESIGN THINKING

---



## UNDERSTAND

CHECK OUT WHAT'S GOING ON. WHAT'S WORKING, AND WHAT'S NOT? WHAT DO PEOPLE NEED?



## DISCOVER

WHAT IS THE EXACT PROBLEM YOU WANT TO SOLVE, AND WHOM ARE YOU SOLVING IT FOR?



## EXPLORE

HOW MANY CRAZY IDEAS CAN YOU COME UP WITH TO SOLVE THIS PROBLEM?!



## CREATE

YOUR IDEA, OUR MATERIALS- LET'S BRING YOUR SOLUTION TO LIFE!



# Activity Mapping

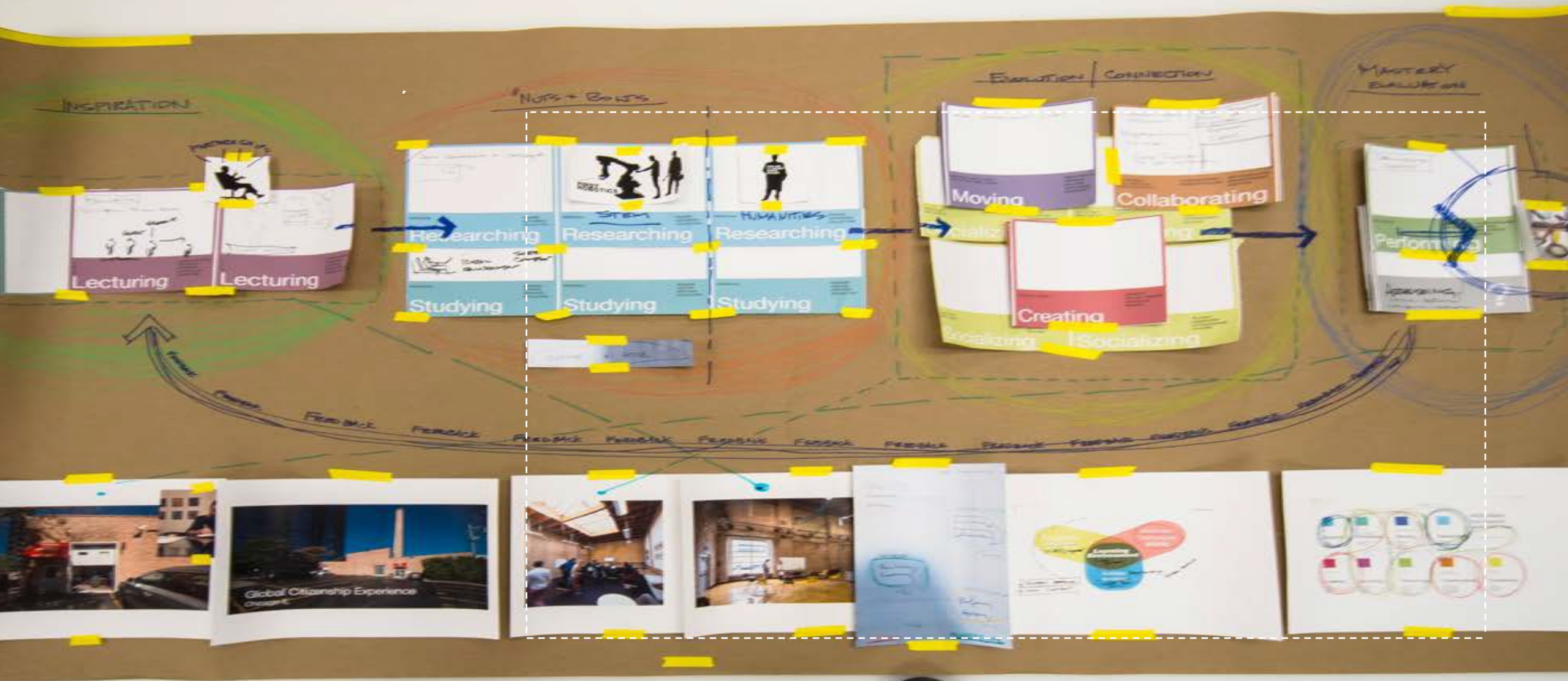

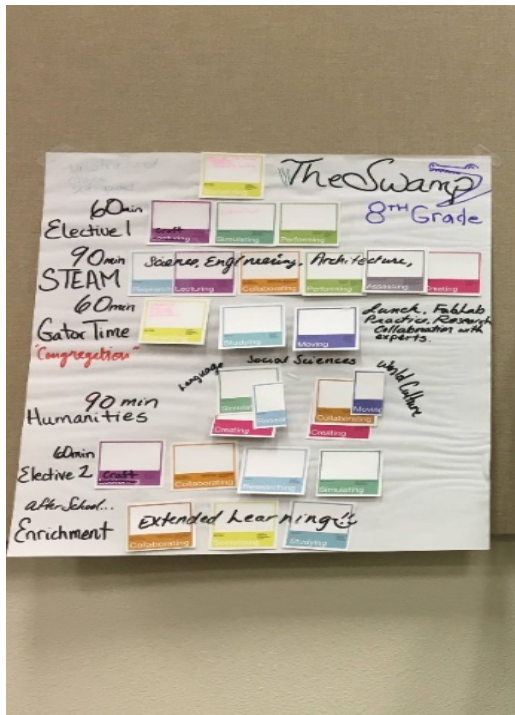

Vision: Gunn Junior High School is a FADL academy that prepares life long learners through creativity, collaboration, communication and critical thinking.

Mission: Students will access academic pursuits through a curriculum that integrates foundational courses, multiple languages and the fine arts.

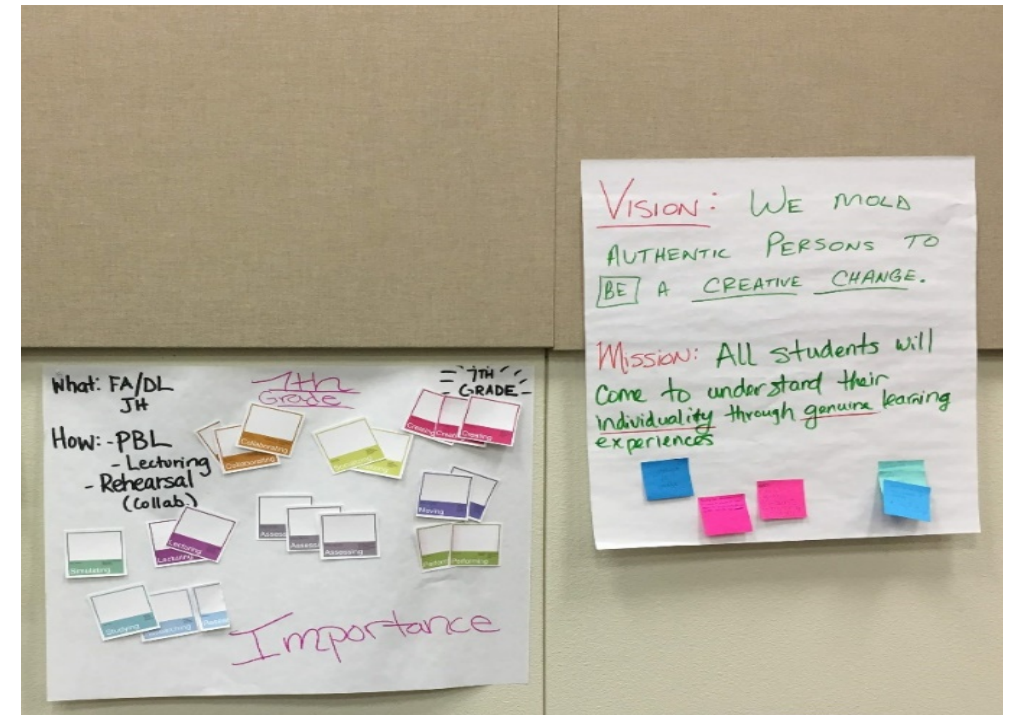

Vision: WE MOLD AUTHENTIC PERSONS TO BE A CREATIVE CHANGE.

Mission: All students will come to understand their individuality through genuine learning experiences

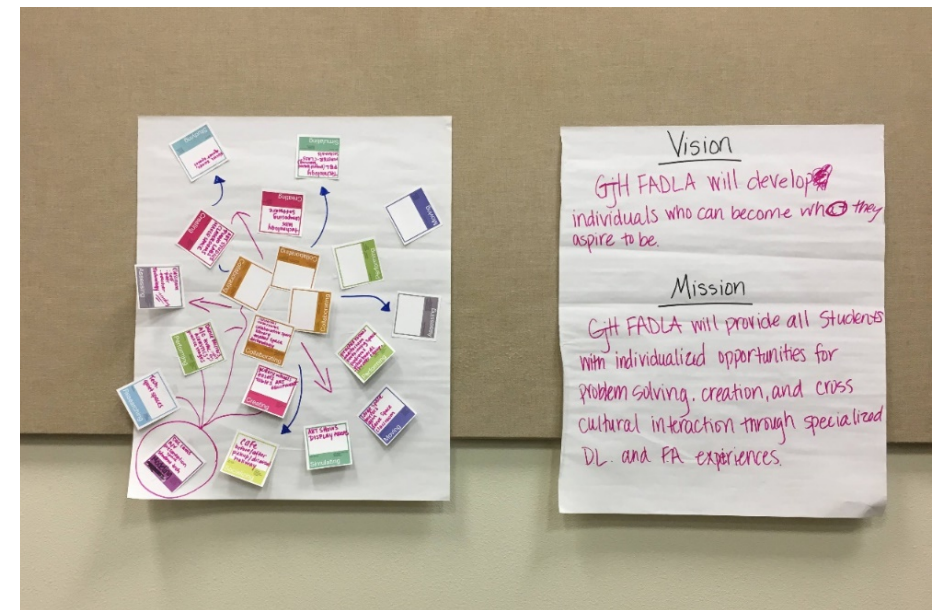
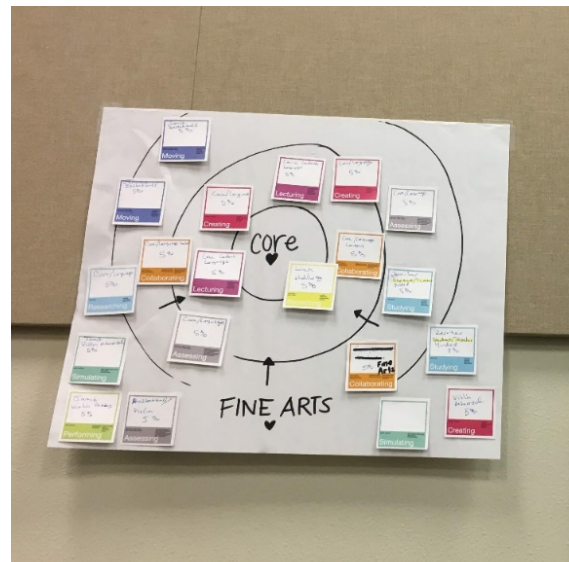

Vision  
GTH FADLA will develop individuals who can become who they aspire to be.

Mission  
GTH FADLA will provide all students with individualized opportunities for problem solving, creation, and cross cultural interaction through specialized DL and FA experiences.

# SPACE KIT ACTIVITY

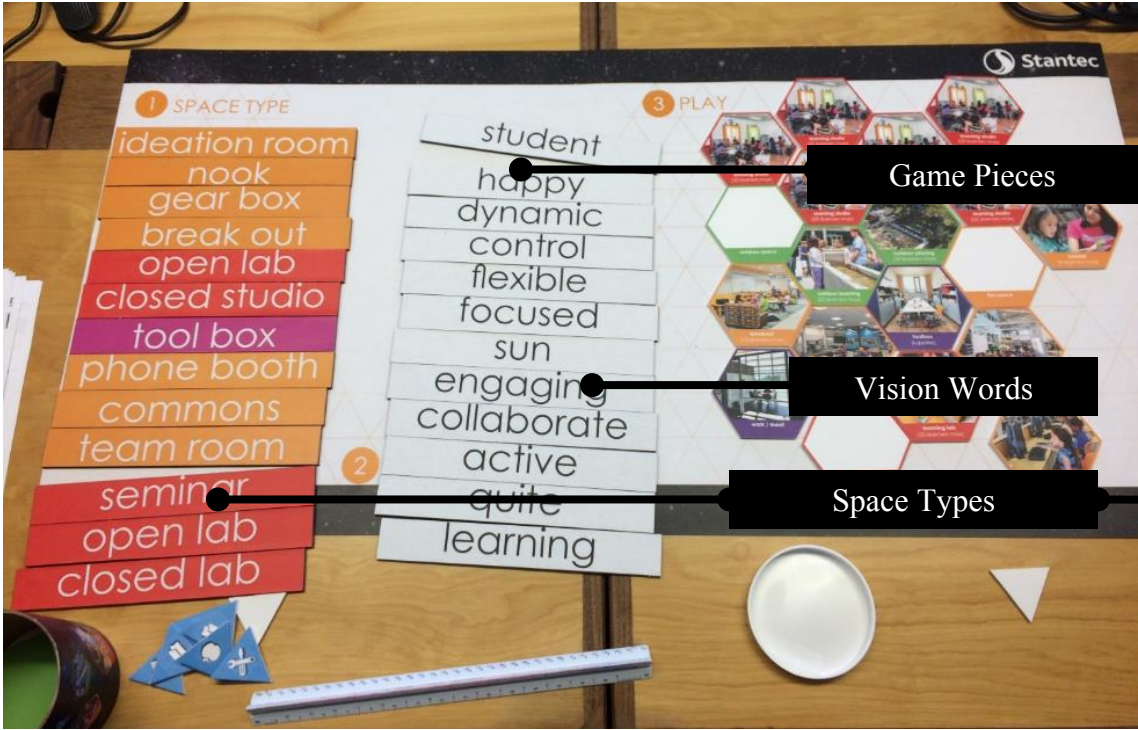

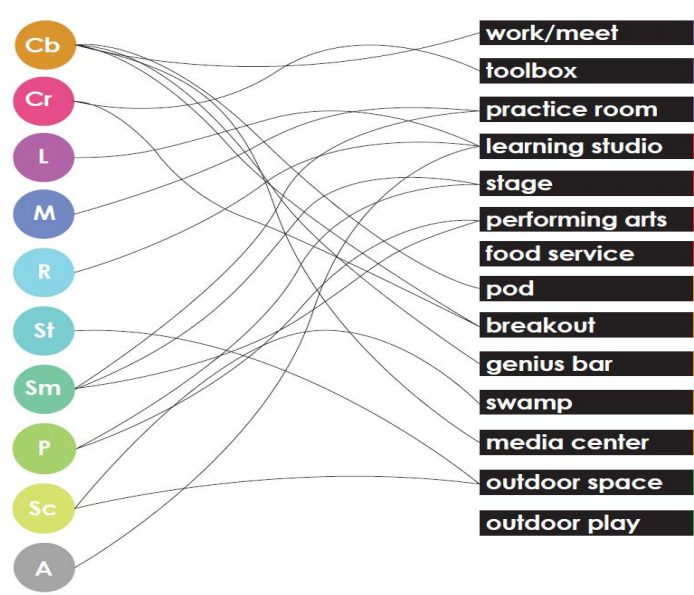

**ACTIVITY + SPACE DIAGRAM**

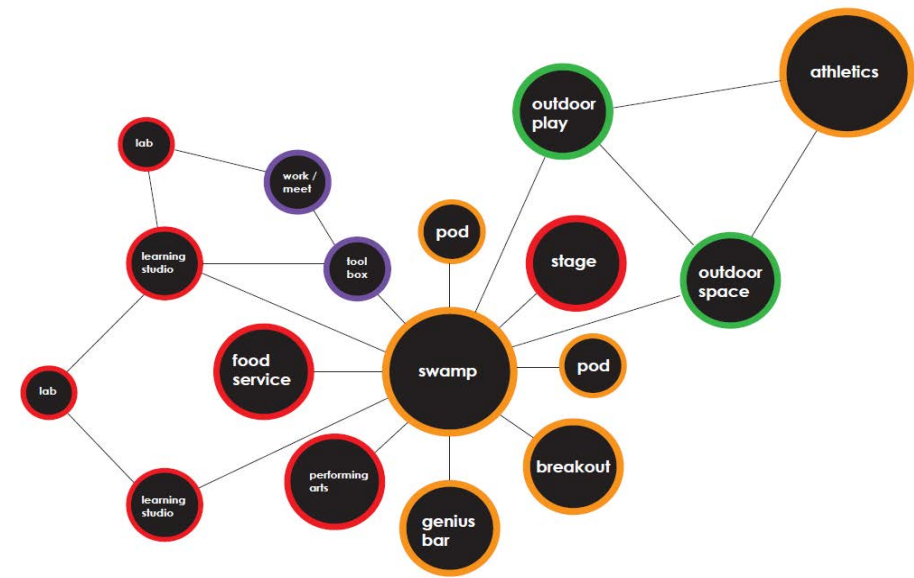

**SPACE RELATIONSHIP MATRIX**

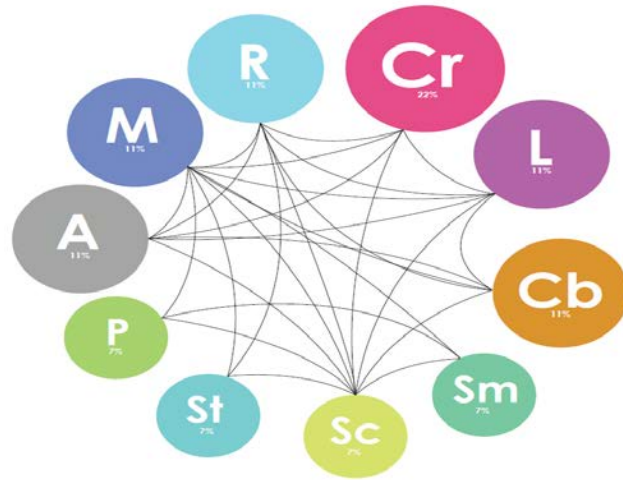

**ACTIVITY MAPPING DIAGRAM**

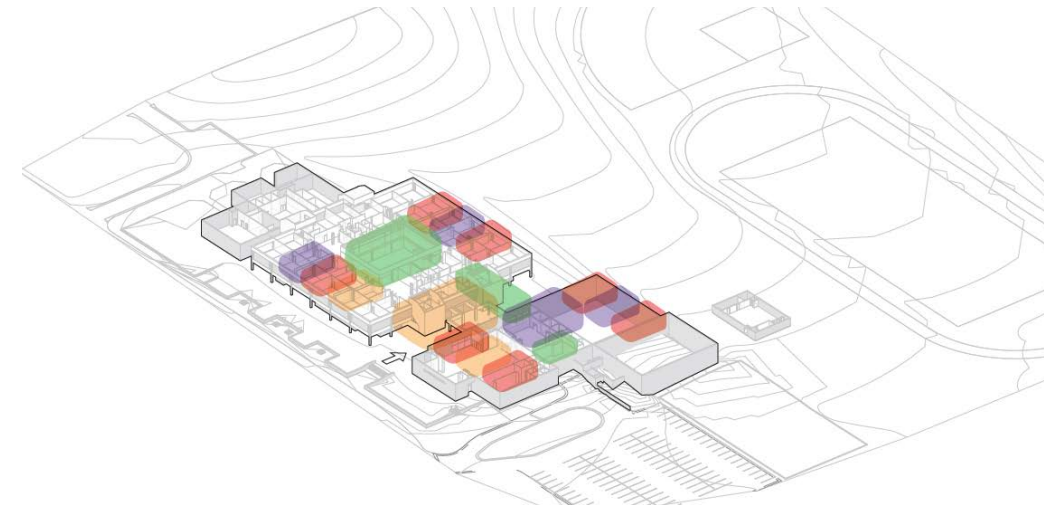

**BUILDING RELATIONSHIP DIAGRAM**





## Schematic Perspective

Gunn Fine Arts + Dual Language Academy



GUNN  
FINE ARTS  
& DUAL  
LANGUAGE  
ACADEMY



**Schematic Perspective**  
Gunn Fine Arts + Dual Language Academy

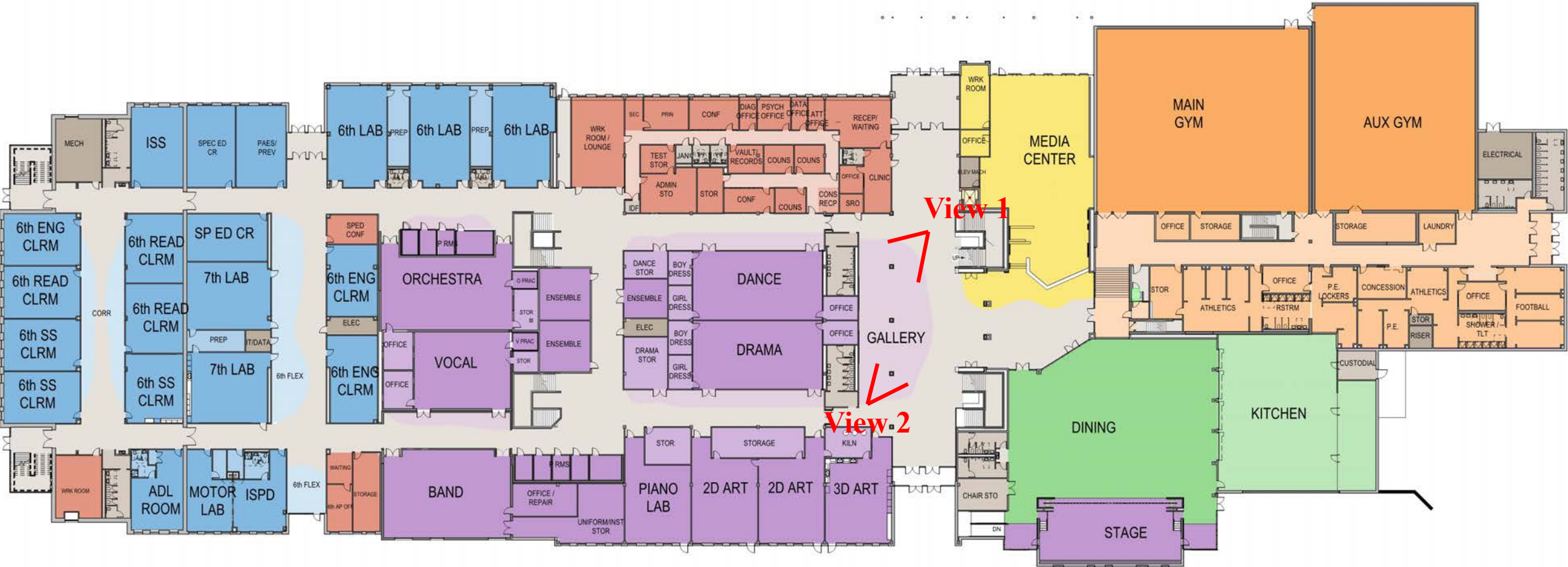

View 1

View 2



# Floor Plan – Level 1

Gunn Fine Arts + Dual Language Academy

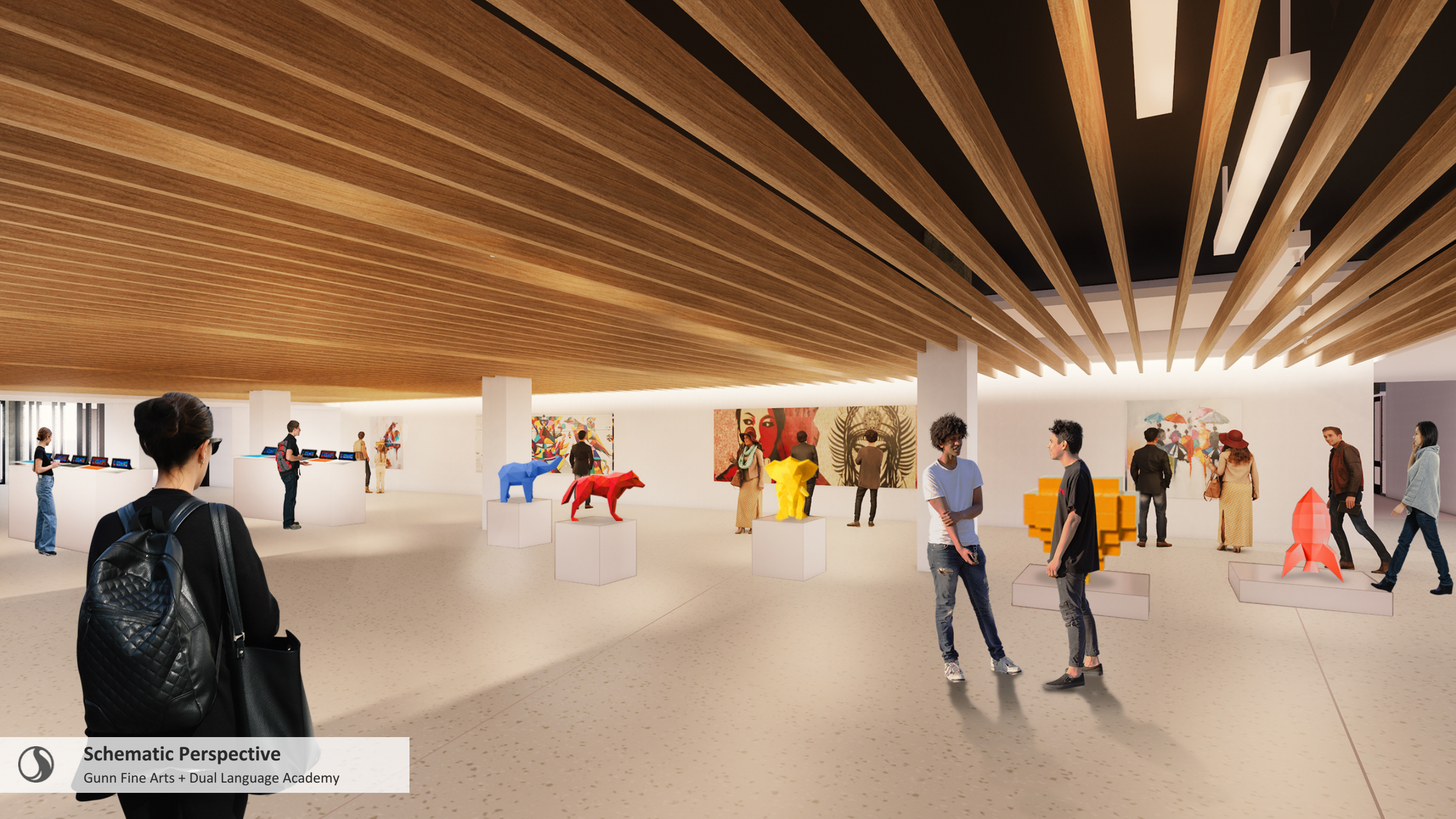

## Schematic Perspective

Gunn Fine Arts + Dual Language Academy



## Schematic Perspective

Gunn Fine Arts + Dual Language Academy





## Schematic Perspective

Gunn Fine Arts + Dual Language Academy





## Schematic Perspective

Gunn Fine Arts + Dual Language Academy



## Schematic Perspective

Gunn Fine Arts + Dual Language Academy



Gunn Fine Arts + Dual Language Academy



## Schematic Perspective

Gunn Fine Arts + Dual Language Academy





## Schematic Perspective

Gunn Fine Arts + Dual Language Academy

- **Instructional design & planning**
- **Program alignment** for a high quality fine arts experience
- **Professional development** and **staffing** for effective implementation
- **Facility readiness** at the high school level

WHAT'S  
NEXT?





